

STEP1. ATTACH MOUNT TO WORK SURFACE

INSTALL ON OPEN EDGE OF WORK SURFACE:

Slide the Base Stem against work surface edge and fully tighten clamp Screw(A).

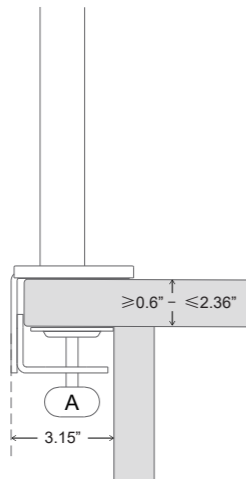

STEP2. INSTALL THE ADAPTOR

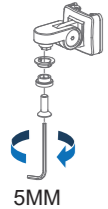

- 1 Remove the screw from the adaptor by the hex wrench.

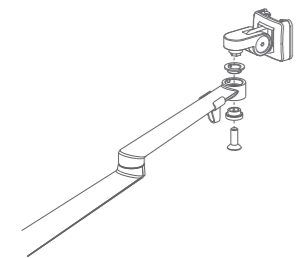

- 2 As the picture shows, put the accessories at the arm, tighten the screw.

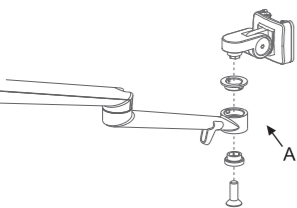

⚠ Note: If you would like to lower the height, Please detach the arm bracket firstly(A), Then insert arm as picture.

STEP3. ATTACH ARM TO THE POLE

As the picture shows, install clip → arm → clip → arm → post cap in order.

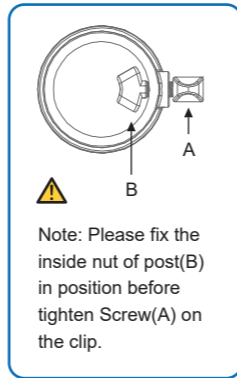
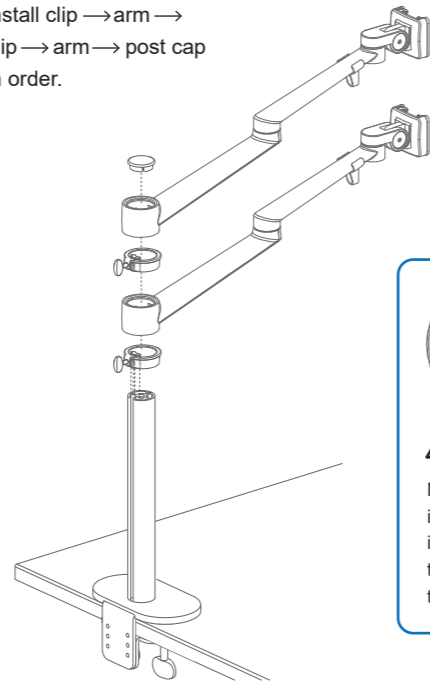

HEIGHT ADJUSTMENT

The Clip could be adjusted on your desired position by losing the screw(A), fix it.

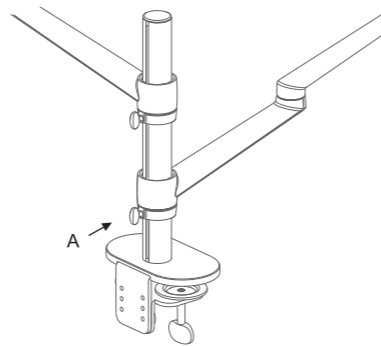

STEP4. ATTACH DEVICES TO ARM

INSTALLING MONITOR

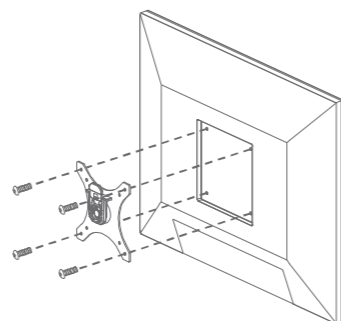

- 1 As the picture shows, install VESA mount on monitor. Be careful to leave the slide clip upwards.

VESA standard:
75*75mm ; 100*100mm

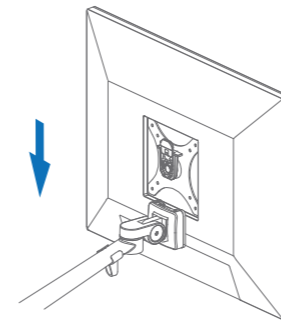

- 2 Insert the VESA connector into the groove, when heard a click sound means done.

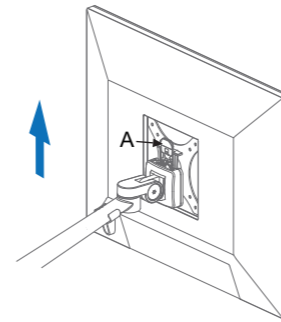

⚠ Note: If you want to remove the device, please press shrapnel (A) to remove the device Up to extract.

INSTALLING LAPTOP PLATE

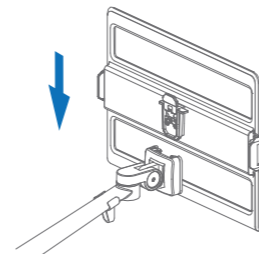

Insert the Laptop Plate into the groove, when heard a click sound means done.

INSTALLING HOLDER

- 1 Remove the screw from the holder adaptor by the hex wrench.

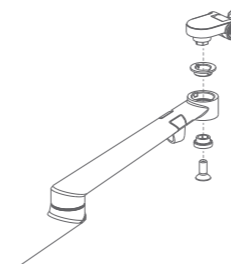

- 2 As the picture shows, put the accessories at the arm, tighten the screw.

- 3 Connecting Holder's cross to adaptor, screw it.

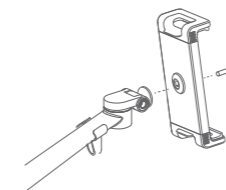

STEP5. CABLE MANAGEMENT

- 1 Remove cable clip (A) from the arm, thread cables, install cable clip on the arm again.

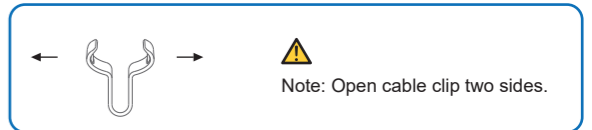
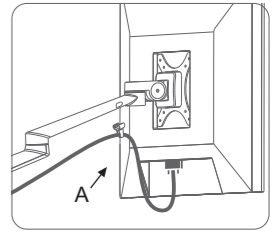

- 2 Slide the plastic cover on the rear arm upwards until it disengages. Put cables onto the plastic cover inside. Slide the cover downwards until it click into place.

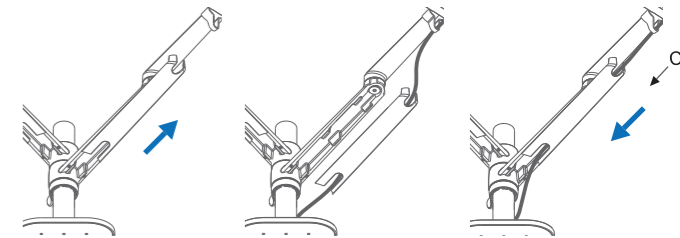

ARM ADJUSTMENTS

TENSION ADJUSTMENT

If you feel the pitching angle too tight or too loose when adjusting the mount, please adjust the Screw.

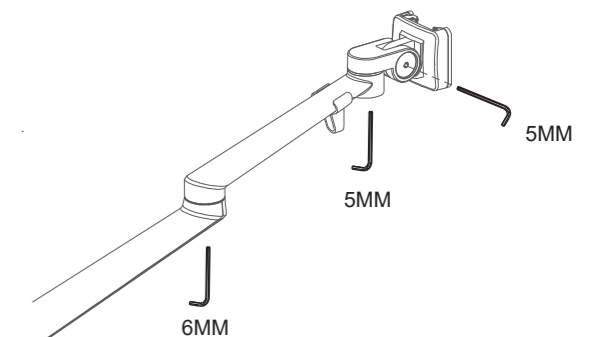

INSTALLATION HARDWARE

WARNING

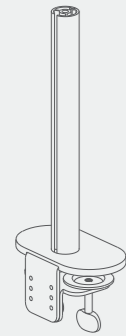

X 1
Base Stem



X 2
Arm



X 2
Adaptor



X 1
Holder Adaptor

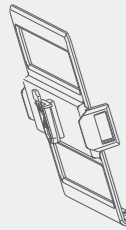

X 1
Laptop Plate



X 1
VESA Connector

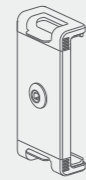

X 1
Tablet Holder



X 6
Screws(M4)



X 6
Screws (M5)



X 1
Holder Screws



X 1
Post Cap



X 2
Clip

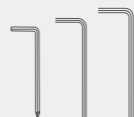

4 / 5 / 6mm
Hex Wrench

- * Make sure to read the manual before installation and fully understand how to install, if you have any questions, please visit our website or contact the relevant after-service.
- * Kindly please make sure the desktop could bear the weight of mount and monitor before installation.
- * Please use the supporting tools when installing, It is better for installation by 2 people. Please be careful.
- * This product contains small parts, keep these away from children.

WARRANTY SERVICE

Never worried when you choose viozon products We offer the best after-sale service to our customer, it only takes few minutes.

Just send you name and order number to



US: service@vio-zon.com
EU: support@vio-zon.com

And then you will get a complete service like The installation guide, Technical support, New product iteration, buy New similar products in advance , promotions, and warranty service from Viozon.

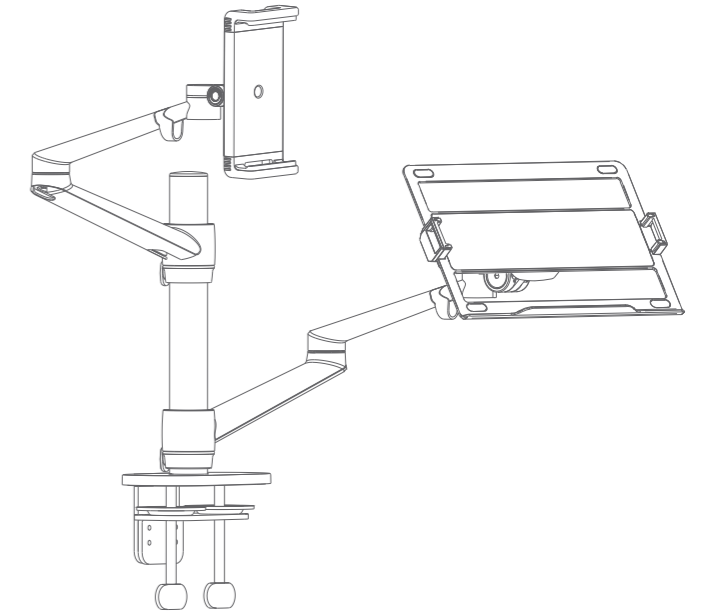

viozon®

FEEDBACK

Share it?
Let us know with a customer review.

Viozon is focus on high-standard product, we believe Customer drive our product upgrades. And write a review that sharing your experience will help other customers , and this will give us great encouragement and confidence.

And if you have any questions, please feel free to contact us without hesitate.

FOR HELP PLEASE CONTACT US:



Facebook: Viozon



US: service@vio-zon.com
EU: support@vio-zon.com



www.vio-zon.com



Scan QR code
to get install video



Scan QR code below for
more products from viozon

OL-3T Installation Instructions